

CE1

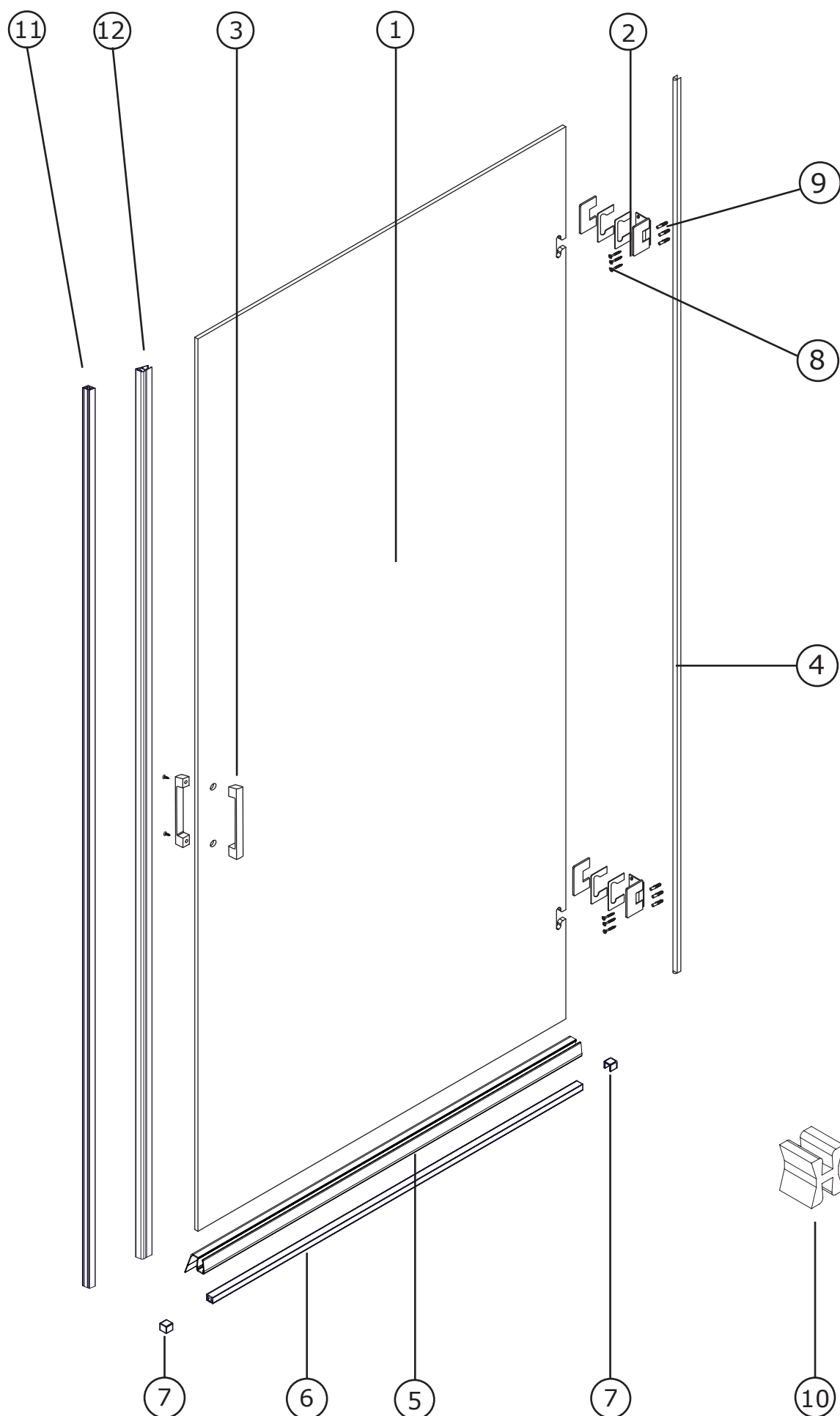

COMPONENTES/COMPONENTS/COMPOSANTS

CODE	DESCRIPTION			UNITS
1	VIDRIO MÓVIL	MOBILE GLASS	PAROI MOBILE	1
2	BISAGRA	HINGE	CHARNIERE	2
3	TIRADOR	HANDLE Z	POIGNÉE	1
4	JUNTA BURBUJA	BUBBLE JOINT	JOINT BULLE	2
5	GOMA INFERIOR	LOWER RUBBER	CAOUTCHOUC INFÉRIEUR	2
6	VIERTEAGUAS	RAIN GUARD	REJETS D'EAU	2
7	REMATE VIERTEAGUAS	FINISH RAIN GUARD	CACHE REJETS D'EAU	2
8	TORNILLO A PARED	WALL SCREW	VIS MURALE	6
9	TACO	WALL PLUG	CHEVILLE	6
10	CALZO	CHOCK	CALE	2
11	CIERRE LATERAL	LATERAL CLOSING	FERMETURE LATÉRALE	1
12	JUNTA MAGNÉTICA	MAGNETIC JOINT	JOINT MAGNETIQUE	1

HERRAMIENTAS NECESARIAS/TOOLS NEEDED/OUTILS NÉCESSAIRES

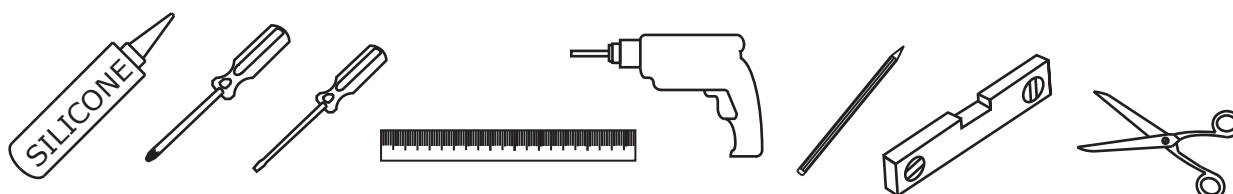

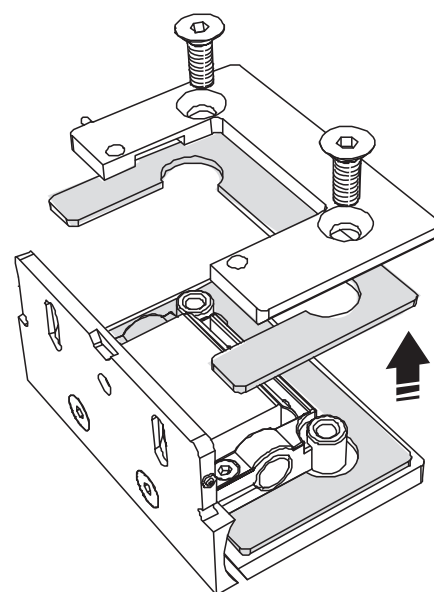
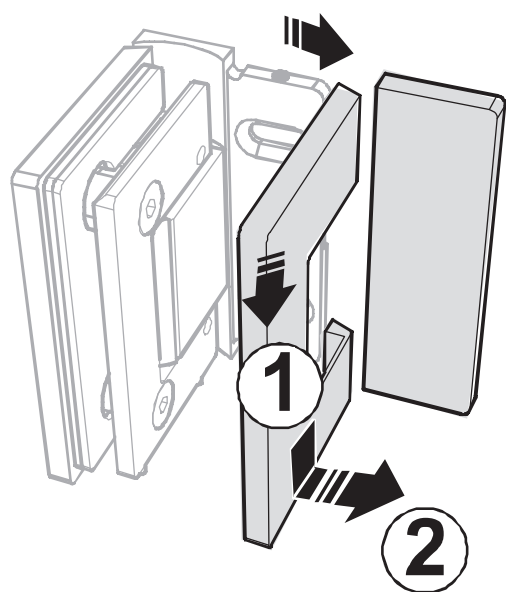

Para vidrio de 8 mm utilizar únicamente el juego de junta grueso y desechar el juego de juntas finas

vidrio
8mm

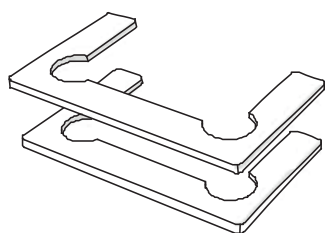

Para vidrio de 10 mm utilizar únicamente el juego de juntas finas y desechar el juego de juntas gruesas

vidrio
10 mm

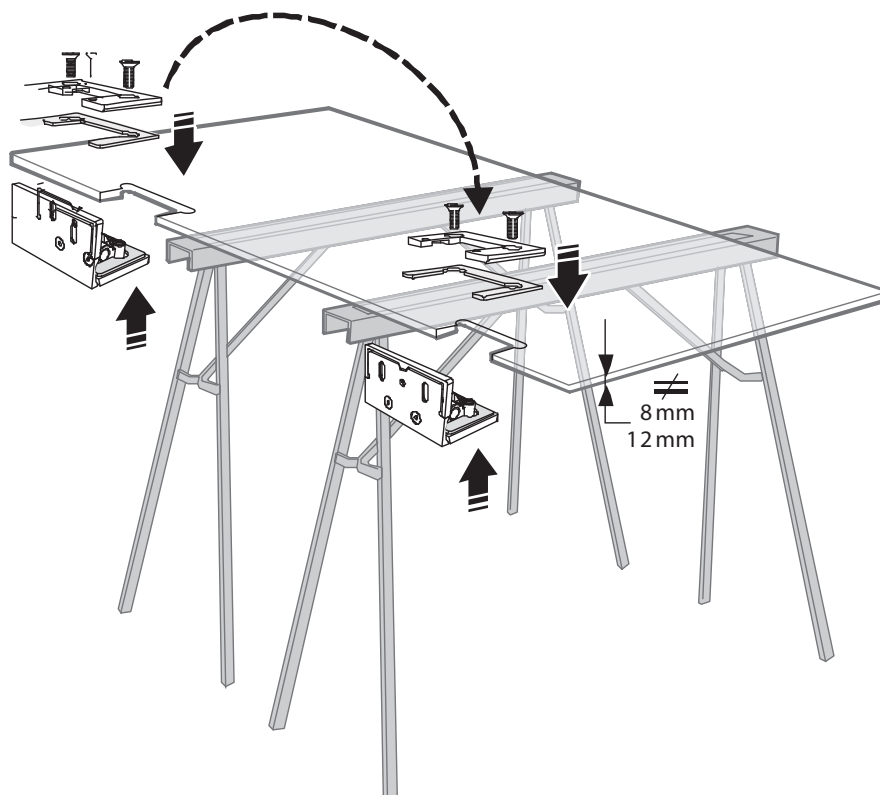
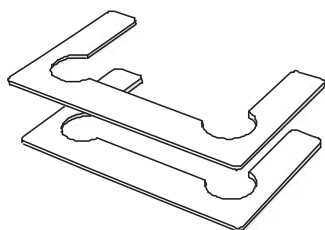

CE1

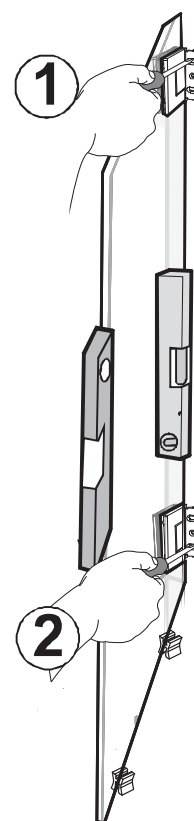
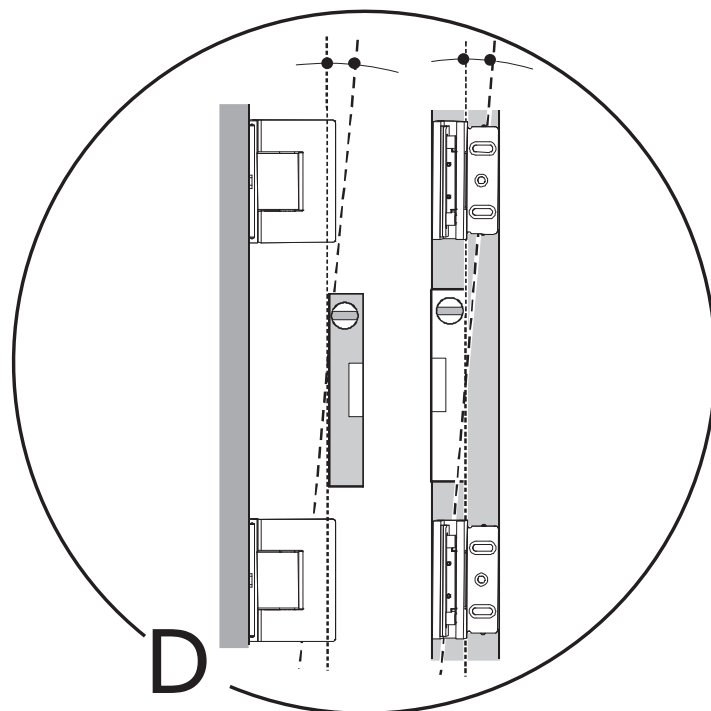
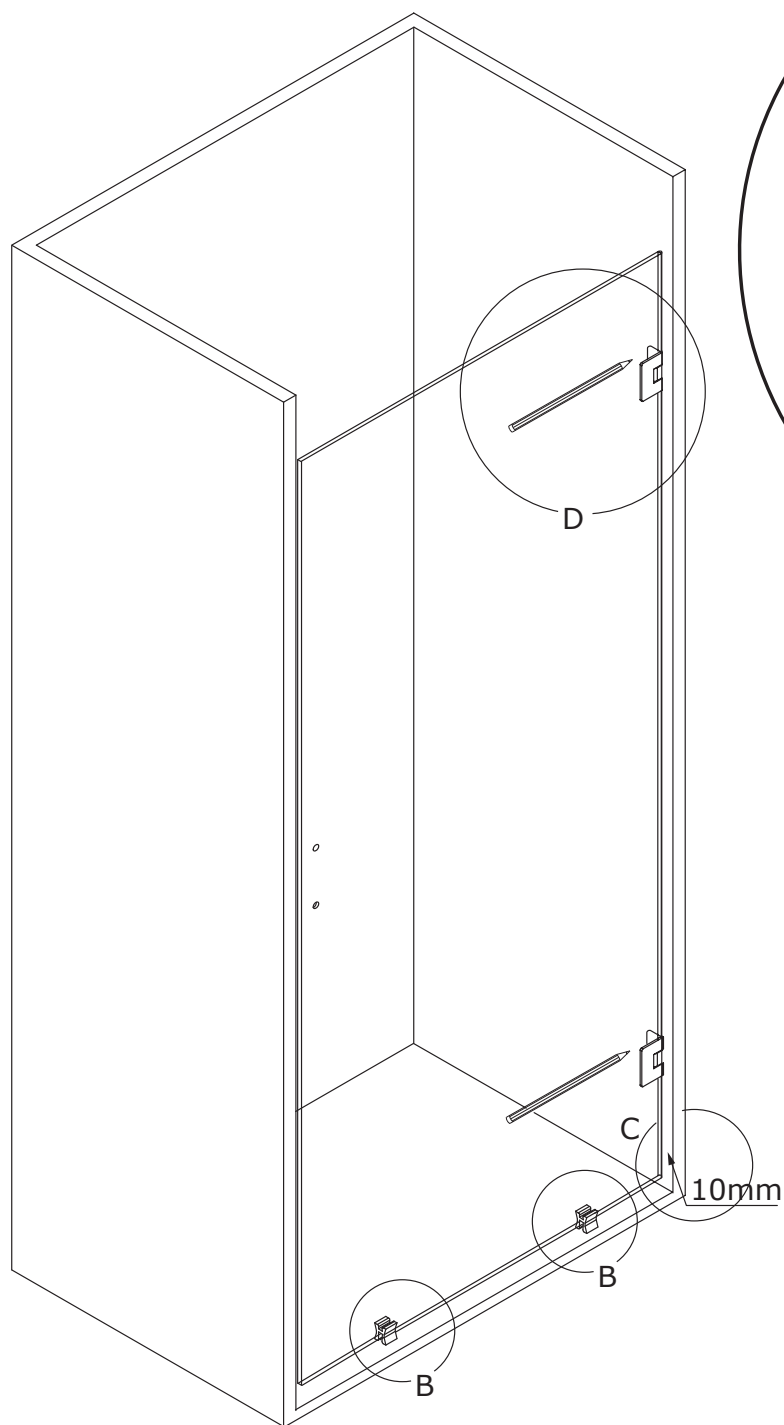

Calzo para montaje de la puerta
a la altura correcta

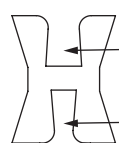

Colocar por este lado Para vidrio de 8 mm

Colocar por este lado Para vidrio de 6 mm

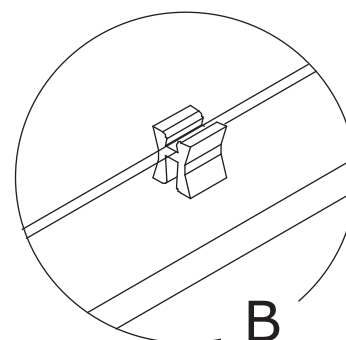
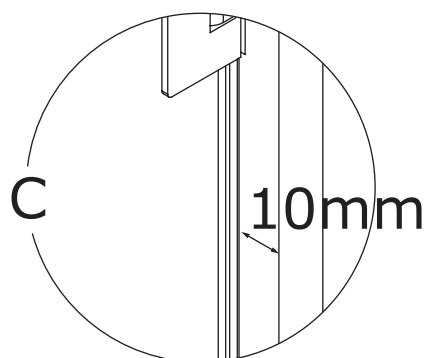

CE1

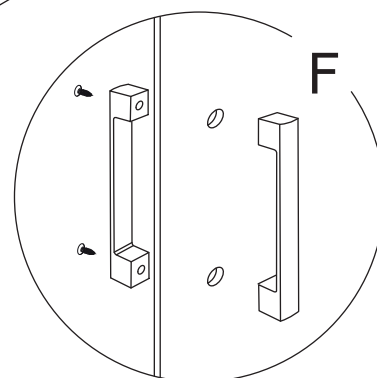
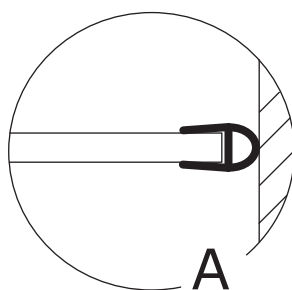
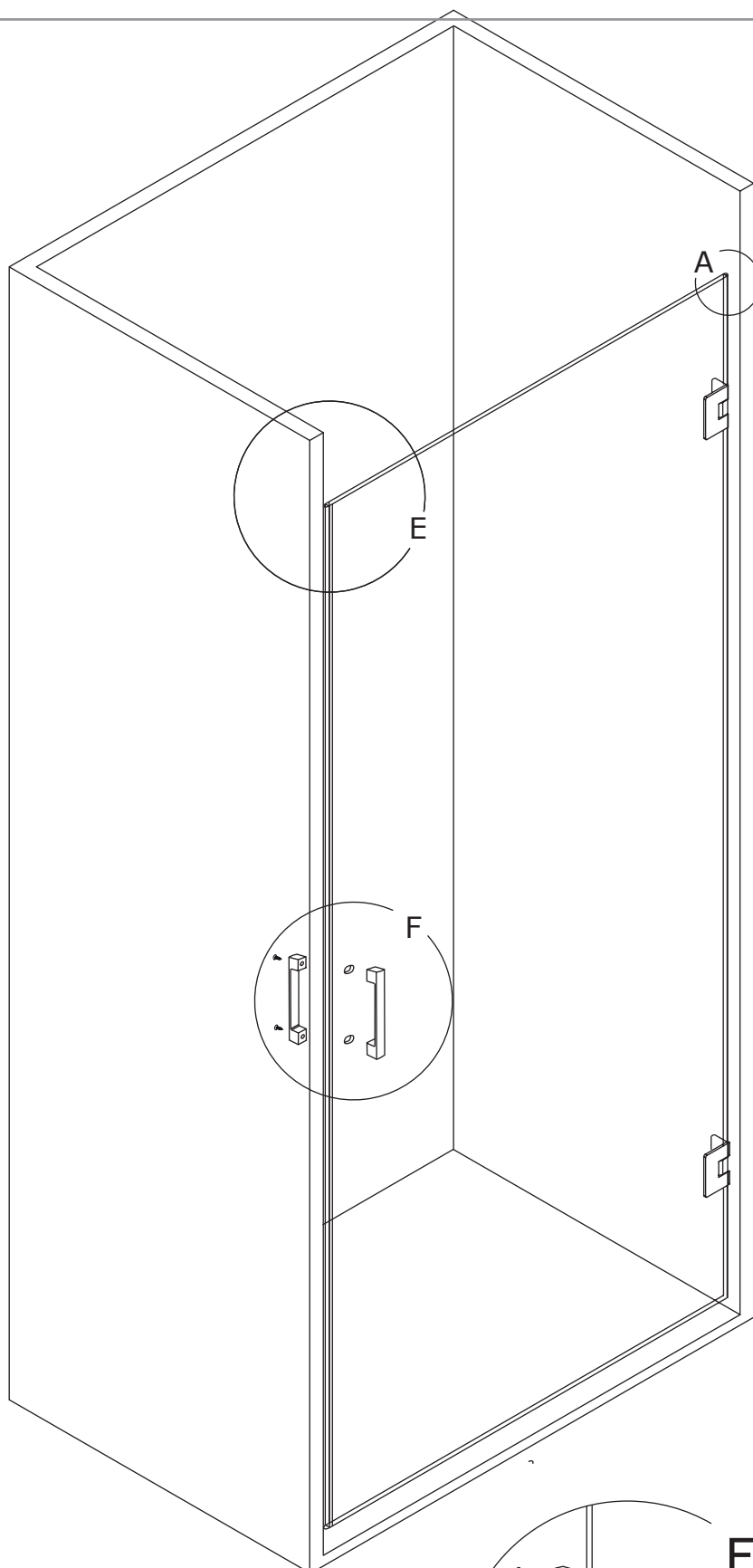
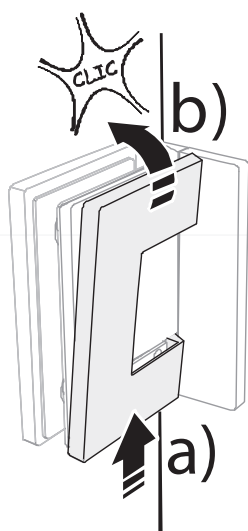
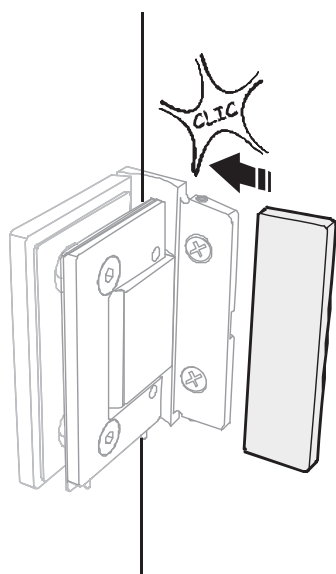
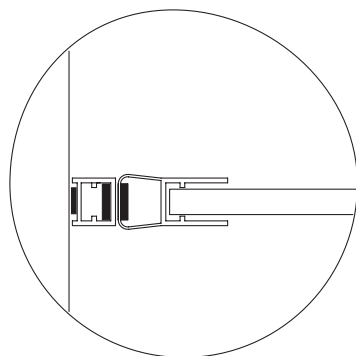
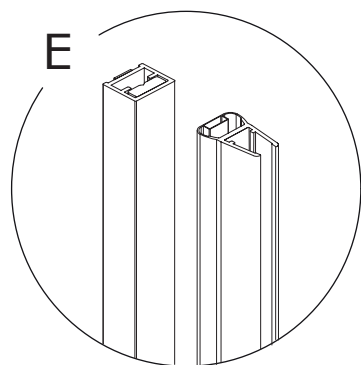

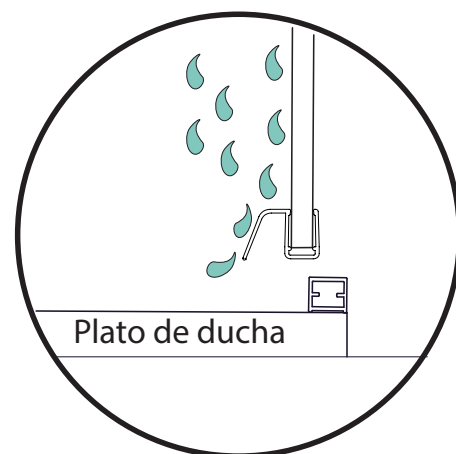
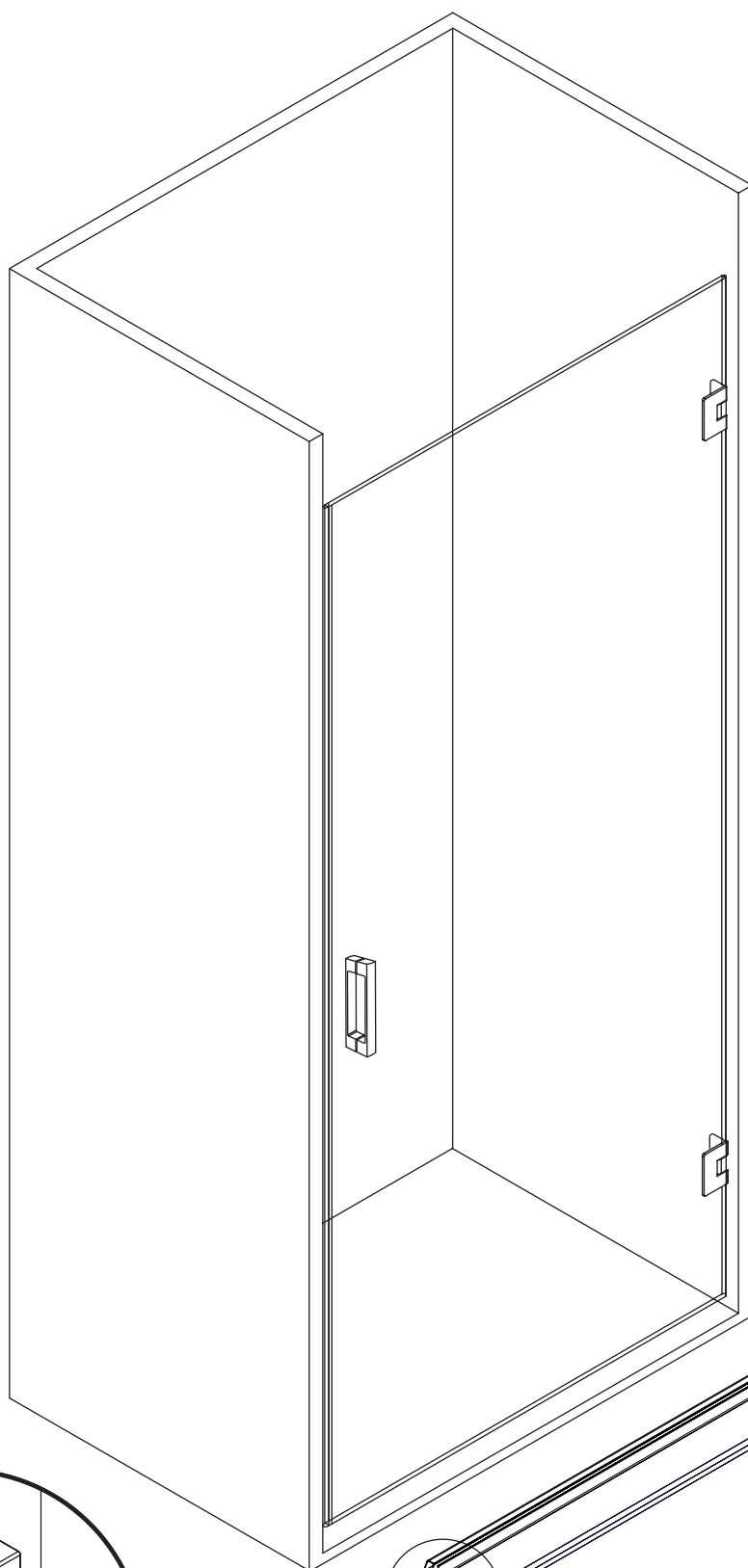

En el caso de que la junta roce demasiado con el vierteaguas, recortar lengüeta para evitar que se pellizque

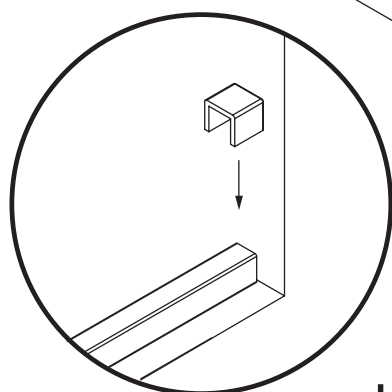
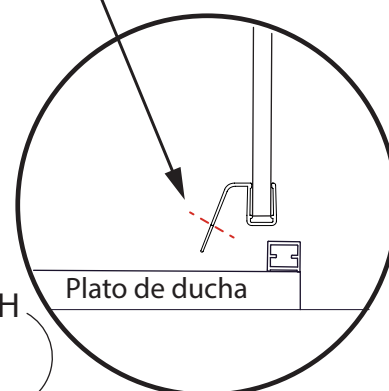
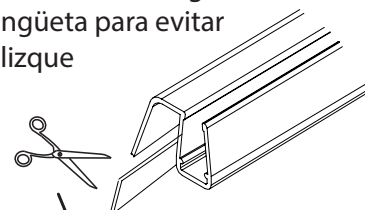

H



G

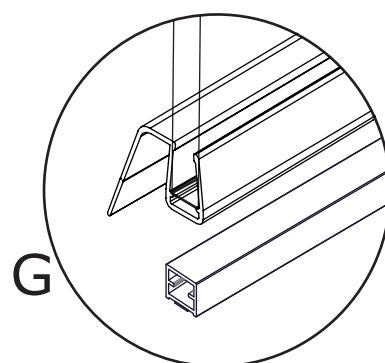

G

ALINEACIÓN
ALIGNEMENT