

CE2AR

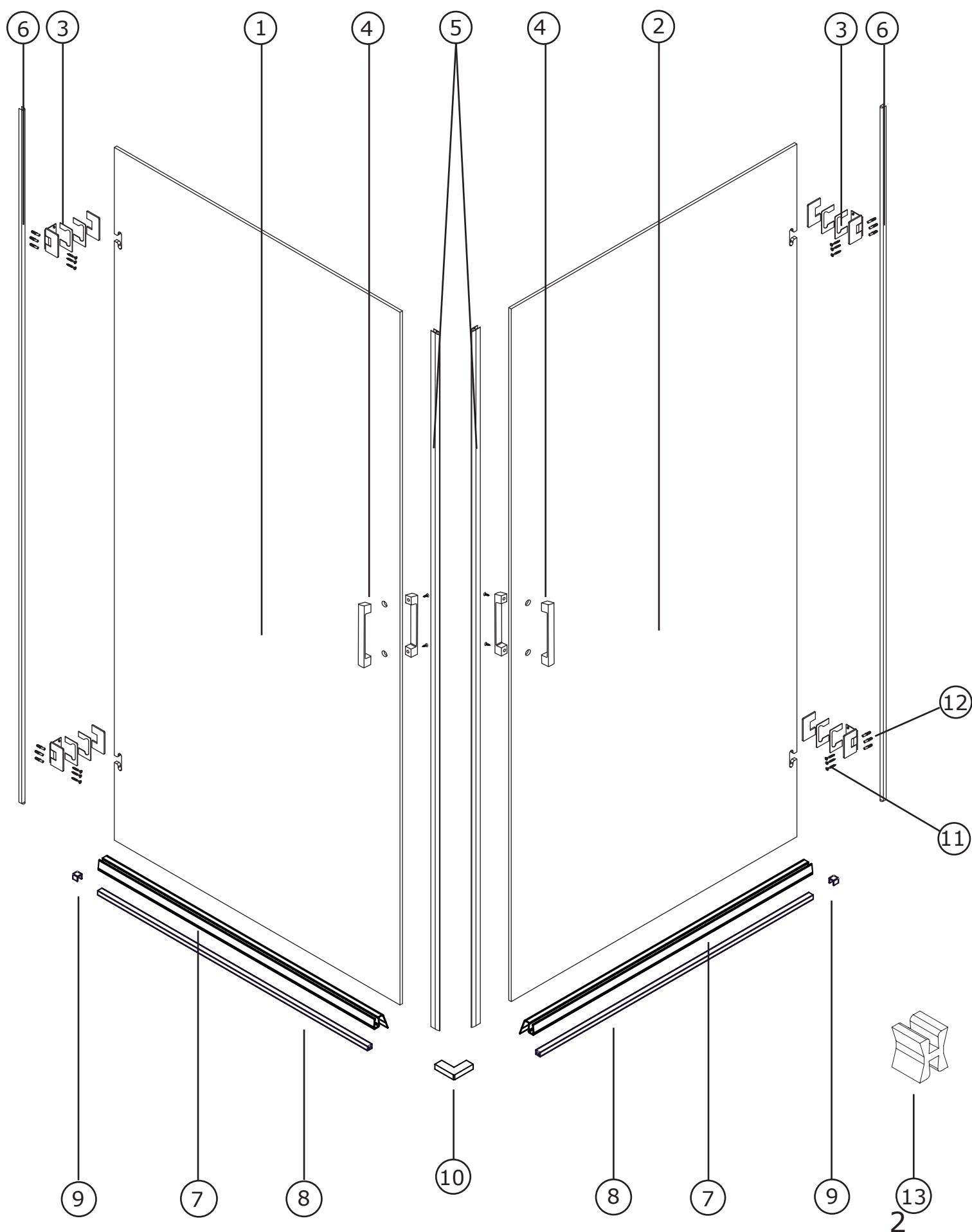

CE2AR

COMPONENTES/COMPONENTS/COMPOSANTS

CODE	DESCRIPTION			UNITS
1	VIDRIO MÓVIL IZQUIERDA	LEFT MOBILE GLASS	PAROI MOBILE GAUCHE	1
2	VIDRIO MÓVIL DERECHA	RIGHT MOBILE GLASS	PAROI MOBILE DROITE	1
3	BISAGRA	HINGE	CHARNIÈRE	4
4	TIRADOR	SHOOTER	TIREUR	2
5	JUNTA MAGNÉTICA	MAGNETIC JOINT	JOINT MAGNÉTIQUE	2
6	JUNTA BISAGRA	HINGE JOINT	JOINT DE LA CHARNIÈRE	2
7	GOMA INFERIOR	LOWER RUBBER	JOINT INFÉRIEUR	2
8	VIERTEAGUAS	RAIN GUARD	REJINGOT	2
9	REMATE VIERTEAGUAS	FINISH RAIN GUARD	COUVERCLE DU REJINGOT	2
10	ESQUINERO VIERTEAGUAS	CORNER RAIN GUARD	REJETS D'EAU D'ANGLE	1
11	TORNILLO A PARED	WALL SCREW	VIS MURALE	12
12	TACO	WALL PLUG	CHEVILLE	12
13	CALZO	CHOCK	CALE	2

HERRAMIENTAS NECESARIAS/TOOLS NEEDED/OUTILS NÉCESSAIRES

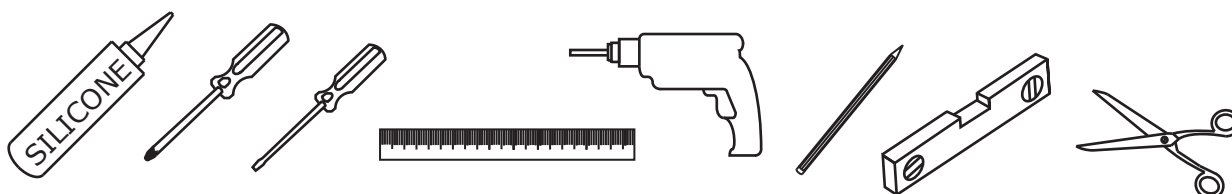

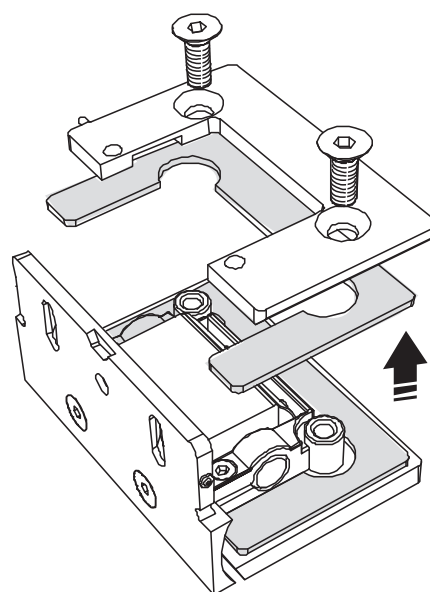
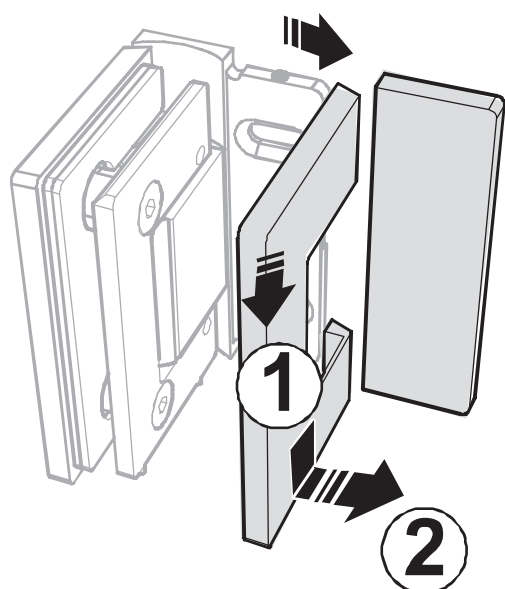

Para vidrio de 8 mm utilizar únicamente el juego de junta grueso y desechar el juego de juntas finas

vidrio
8mm

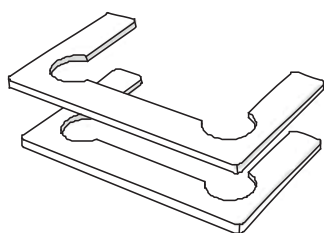

Para vidrio de 10 mm utilizar únicamente el juego de juntas finas y desechar el juego de juntas gruesas

vidrio
10 mm

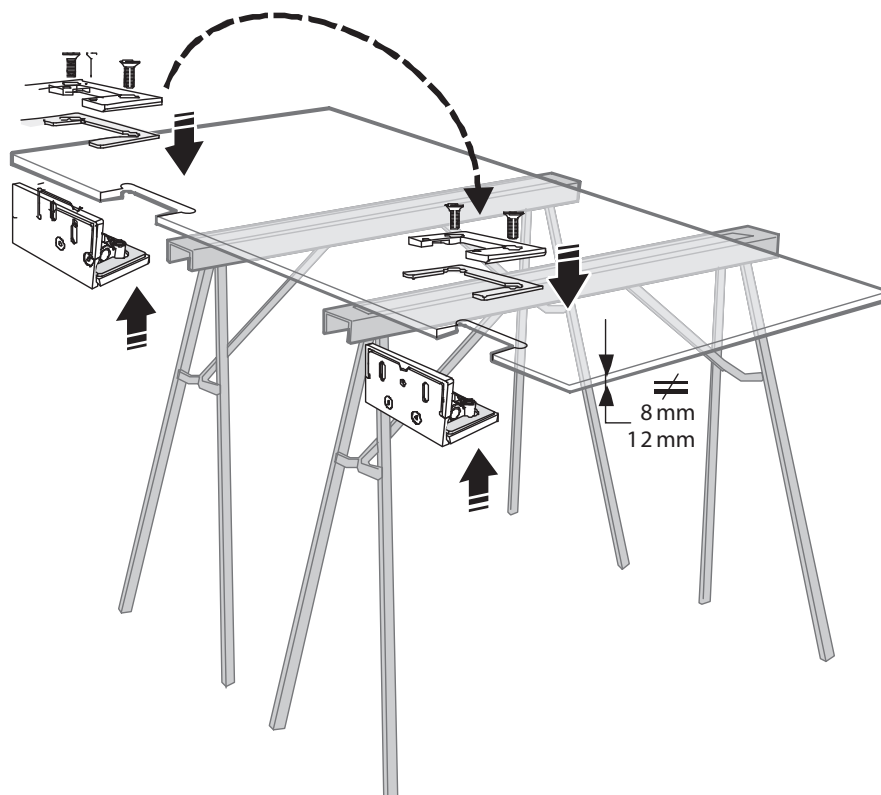
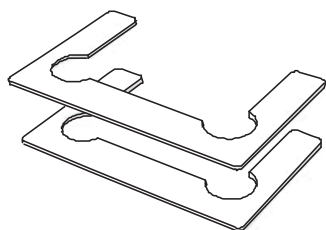

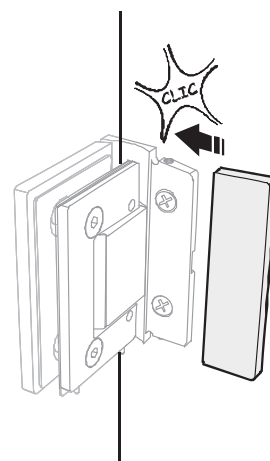
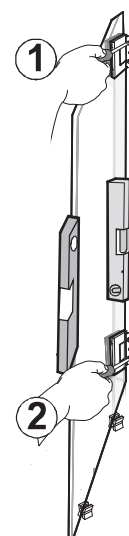
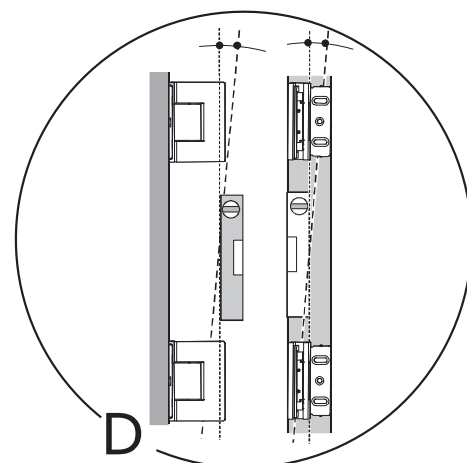
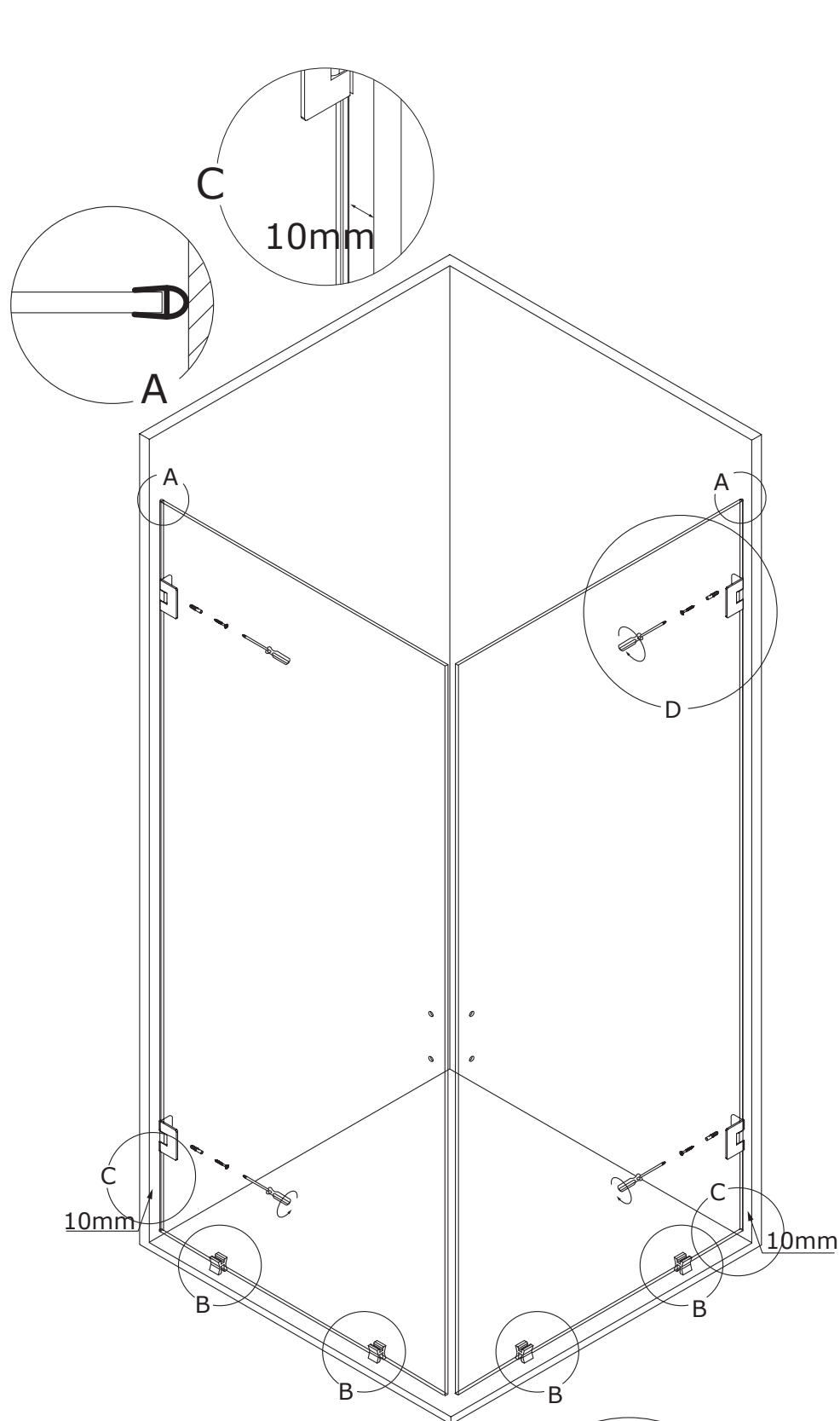

Calzo para montaje de la puerta a la altura correcta

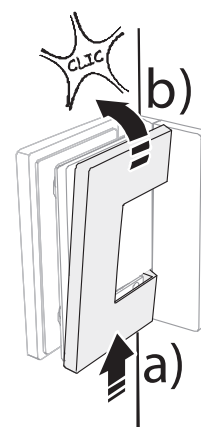
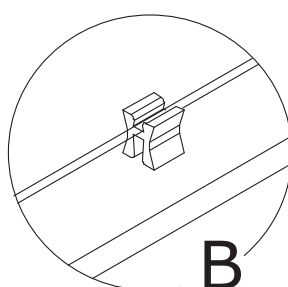
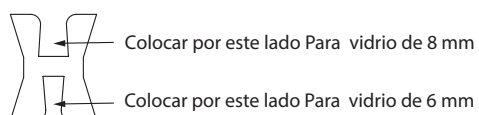

CE2AR

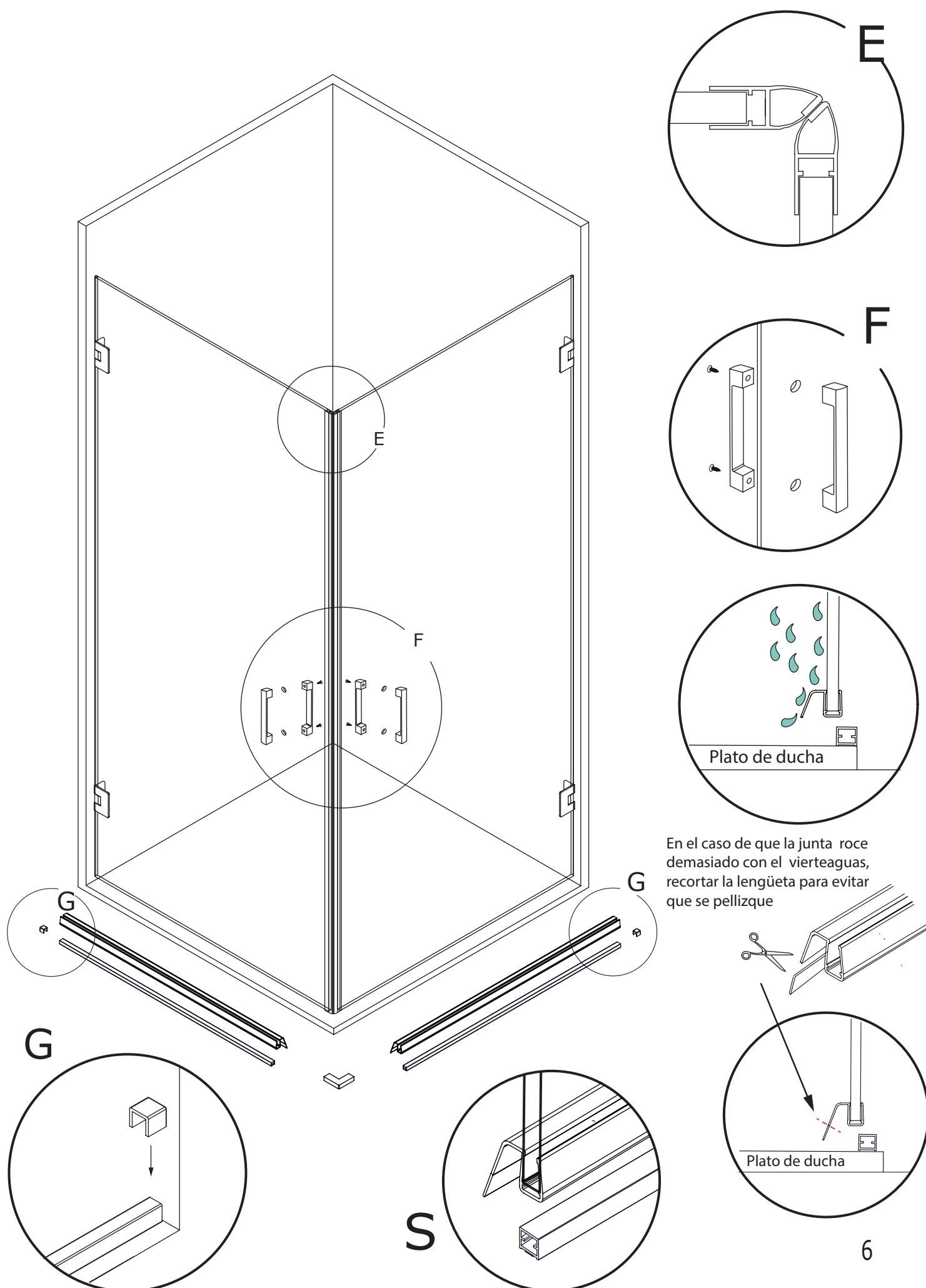

ALINEACIÓN
ALIGNEMENT

